

Scale: 1" = 20'-0"

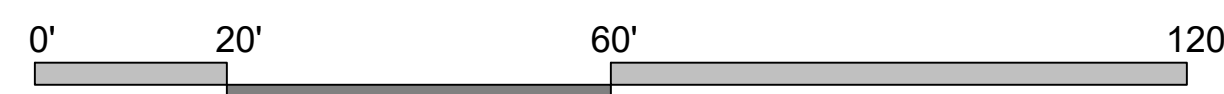
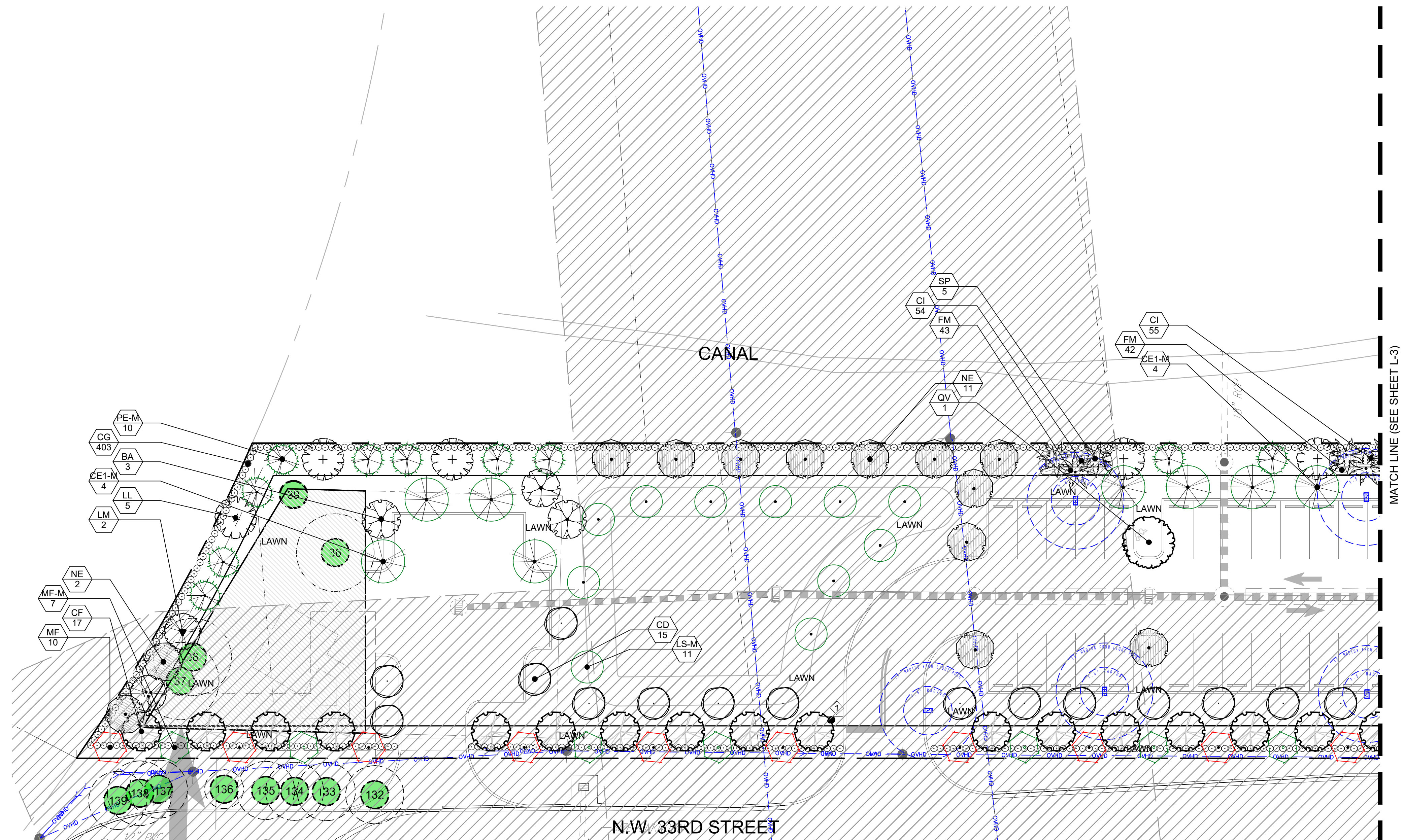

Note: Visibility and unobstructed working space must be maintained from fire apparatus access routes to fire protection and life safety appliances/equipment. The only landscaping should be grass or mulch no plants or shrubs. These include but not limited to: Fire hydrants, fire department connections (FDC), post indicating valves (PIV), fire sprinkler risers, fire alarm control panels and electrical room locations require a minimum 36-inch clearance path to and on all sides. Fire hydrants require 36-inch clear space each side and rear with a 60-inch wide clear access from the fire apparatus access to fire hydrant. (NFPA 1-2021 Ch. 18 Sec. 18.5.7)

[illegible]

Seal:

Lic. # LA6667290
Member: A.S.L.A.

Drawing: Landscape Plan

Date: 11/05/2025

Scale: See Left

Drawn by: MAV

Sheet No.: 0043
26

Cad Id.: 2025-060

L-2

WITKIN HULTS
 + PARTNERS
 307 south 21st avenue hollywood, florida
 phone: 954.923.9887 facsimile: 954.923.9889
 www.witkindesign.com

©2000 WITKIN HULTS + PARTNERS
 THE DESIGN AND DRAWINGS HEREIN ARE THE
 INTELLECTUAL PROPERTY OF THIS
 LANDSCAPE ARCHITECT AND ARE PROTECTED
 UNDER THE COPYRIGHT PROTECTION ACT

Project: **FESTIVAL FLEA MARKET SOUTH**
NW 27TH AVE & NW 33RD STREET, POMPANO BEACH, FL
LANDSCAPE PLAN